

A Hamilton Microlab 300 Pipettor is shown in the background, featuring a digital display with a pipette tip icon and a green arrow pointing up. The display shows 'Tip Size 1 mL' and 'Sample Volume 1000.0 µL'. Below the display are buttons for 'Run', 'Empty Tip', 'Favorites', and 'Advanced'. The Hamilton logo is visible on the front of the device. In the foreground, a hand wearing a blue nitrile glove holds a white pipette tip, with a small amount of blue liquid visible inside. The background is a light blue gradient.

HAMILTON®

Microlab 300 Pipettor

**Minimer pipetteringsfeil
samtidig som jobben
blir enklere!**

**Ta kontakt
for mer info:**

23 600.-
(eks mva. & frakt)



**Chiron AS Stiklestadvn. 1 N-7041 Trondheim Tlf: +47 73 87 44 90
Fax: +47 73 87 44 99 E-post: salg@chiron.no www.chiron.no**

Microlab[®] 300

Guided Pipetting System

Minimize Pipetting
Errors While Making
Your Job Easier

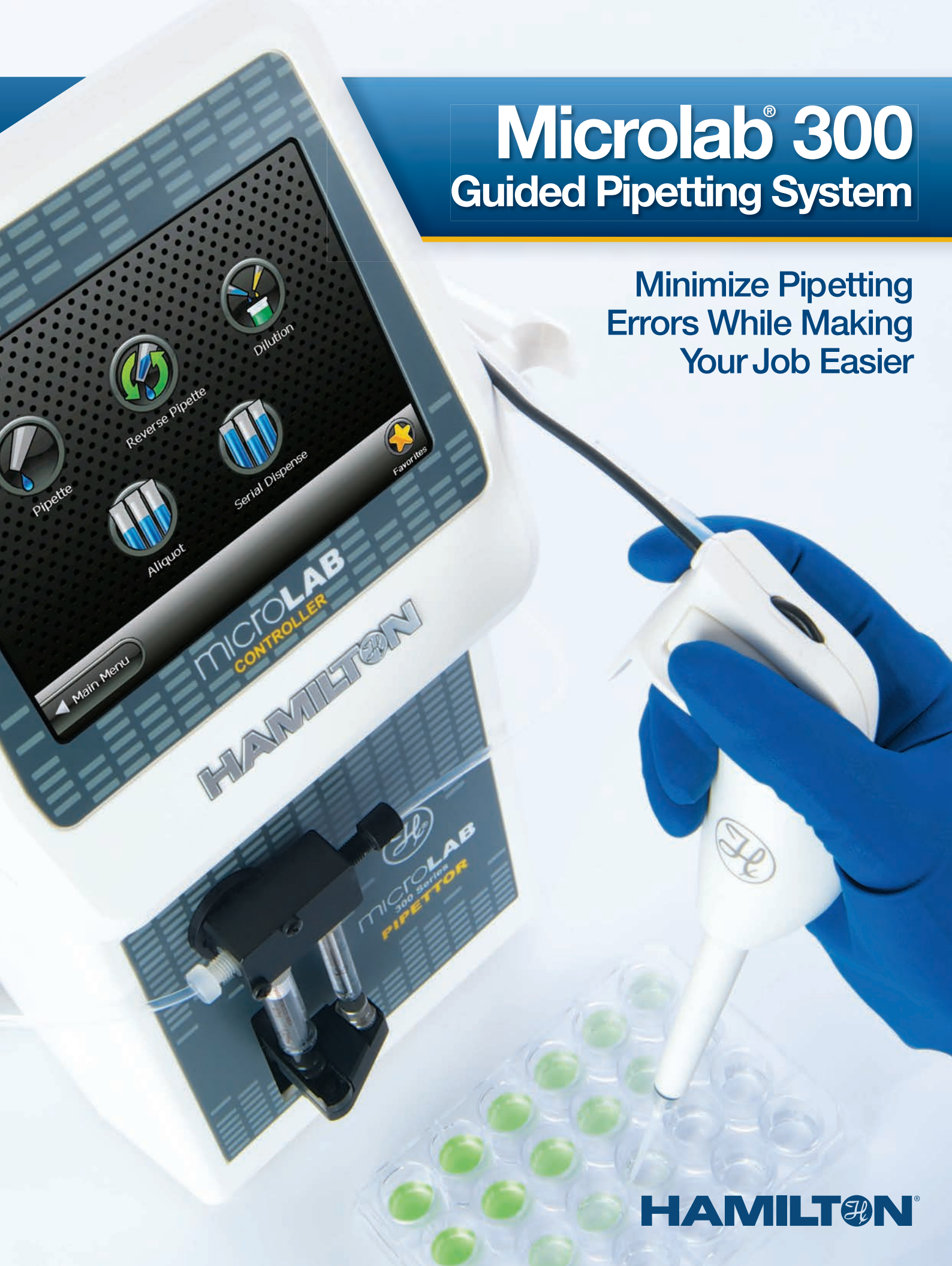

HAMILTON

Take Control of Your Pipetting

► Guided Protocols

Run-only methods reduce errors with on-screen instructions and automatic volume adjustment to guide the user.

► User-Friendly Software

Quickly create and run protocols with an intuitive touch screen interface.

► Reduced Fatigue

Minimize strain with the lightest pipette probe in the industry.

► Improved Accuracy

Automatically compensate for unique atmospheric and liquid properties.



Cable Management System

Innovative Software

An easy-to-use graphical interface uses animations to clearly indicate each pipetting step.

Pipette Holder

Accuracy from 0.5 μL –1 mL

The intelligent syringe drive utilizes a large and small syringe to achieve accuracy and precision across a wide volume range.



Understanding the Guided Pipetting System

The Microlab 300 ensures pipetting results with easy-to-use software that instructs users through controlled protocols. Obtain the performance of a fully automated liquid handling platform with the flexibility and affordability of a manually controlled process.

If you're still pipetting the old way, contact a Hamilton representative today and take control of your pipetting.

Favorites Selection

Quickly access favorite dispense volumes using the probe scroll wheel.

Left or Right Handed Design

Lightweight Hand Probe

Spring-Assisted Tip Ejection

ClickSure™ Tips



Pipette Wizards

User-directed pipette Wizards provide flexibility while maintaining pipetting integrity with digital volume and speed adjustment. Commonly used volume settings are saved as Favorites and recalled at the touch of a button. Pipetting operations include:



Pipette



Mix



Serial
Dispense



Reverse
Pipette



Aliquot



Dilution

Linked Methods

Use Linked Methods to program a series of pipetting operations into a guided electronic protocol. Technicians run these protocols and on screen instructions guide them through each pipetting task, thus increasing productivity and reproducibility while minimizing pipetting errors.

Steps:

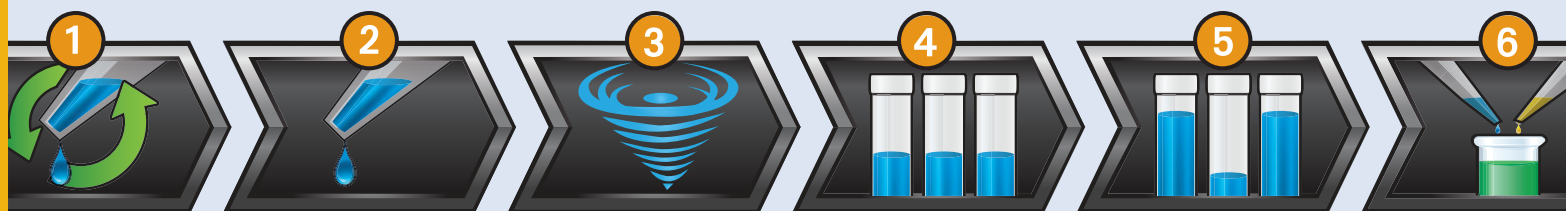

On-Screen Instructions

Graphical animations guide the user through each pipetting task. Instructional text prompts can be added to provide the technician additional guidance at each step.



System Security

Create user accounts and set access rights for each user. Assign technicians run-only rights to ensure that once a method is established it cannot be accidentally modified without approval.



Method Logging

Enable method logging to create auditable records of all pipetting activities. Electronically sign 21 CFR Part 11-compliant log files or print hard copies directly from the controller to provide traceability of the operator, time of day, pipetting actions, last calibration date, etc.

Microlab 300 Series Pipettor Ordering Information

Part Number	Description
67100-01	Microlab 300 Series Pipettor ships complete with a Disposable Tip Hand Probe, Syringe Drive and Controller, and Cable Management System.
61500-04	Printer Kit (optional)

Accuracy and Precision



Dispense Volume (µL)	1.0	5.0	10	25	50	100	250	500	1000
Accuracy (±%)	6.00%	1.50%	1.00%	0.85%	0.80%	0.80%	0.75%	0.75%	0.40%
Precision (+%)	6.00%	1.00%	0.90%	0.60%	0.50%	0.80%	0.75%	0.35%	0.15%

Pipetting specifications were determined gravimetrically using precise pipetting technique and strictly controlled environmental conditions: test temperature: $20 \pm 2^\circ\text{C}$, relative humidity: $50\% \pm 5\%$, test liquid temperature range: $\leq \pm 0.5^\circ\text{C}$ of room temperature, balance used: Mettler Toledo MX5. The measurements were performed using deionized water with Hamilton ClickSure pipette tips (1000 µL ClickSure tips were used for data points above 50 µL while 50 µL ClickSure tips were used for datapoints ≤ 50 µL). Results may vary due to environmental conditions or when using other liquids.

ClickSure Tips

Less force, more comfort. Hamilton's competitively priced ClickSure tips are validated to provide superior accuracy and precision. The unique design requires low force to load and eject tips, enabling long-term use with minimal hand strain. The environmentally friendly packaging is recyclable for eco-conscious labs.

ClickSure Tips Ordering Information

Description	Part Number
	
50 µL, non-sterile ClickSure tips, 960 tips racked	235537
50 µL, non-sterile ClickSure tips, 960 bulk	235543
50 µL, sterile ClickSure tips, 960 tips racked	235536
50 µL, sterile, filtered ClickSure tips, 960 tips racked	235544
	
1 mL, non-sterile ClickSure tips, 960 tips racked	235539
1 mL, non-sterile ClickSure tips, 960 bulk	235545
1 mL, sterile ClickSure tips, 960 tips racked	235538
1 mL, sterile, filtered ClickSure tips, 960 tips racked	235546

© 2013 Hamilton Company. All rights reserved.
All trademarks are owned and/or registered by Hamilton Company in the U.S. and/or other countries.
Lit. No. L70063-Rev.B — 11/2013

HAMILTON®

Web: www.hamiltoncompany.com
USA: 800-648-5950
Europe: +41-81-660-60-60

Hamilton Americas & Pacific Rim
Hamilton Company Inc.
4970 Energy Way
Reno, Nevada 89502 USA
Tel: +1-775-858-3000
Fax: +1-775-856-7259
sales@hamiltoncompany.com

Hamilton Europe, Asia, & Africa
Hamilton Bonaduz A.G.
Via Crusch 8
CH-7402 Bonaduz, GR, Switzerland
Tel: +41-81-660-60-60
Fax: +41-81-660-60-70
contact@hamilton.ch

To find a representative in your area, please visit hamiltoncompany.com/contacts.